



**Transmate**

1-800-426-9341



# TapMate™ XL-424 Main Drilling Machine

**Material Specifications**

- 4" - 24" Taps.
- 300 PSI pressure rating.
- Can be used with existing TapMate and QuikValve equipment.
- Base Machine weighs 285 lbs.
- Taps any pipe commonly used in underground water mains.
- Storage crate functions as a workstation with storage space for tools, pilots and other accessories.
- Over 39 inches of travel.
- Integrated hydraulic motor.

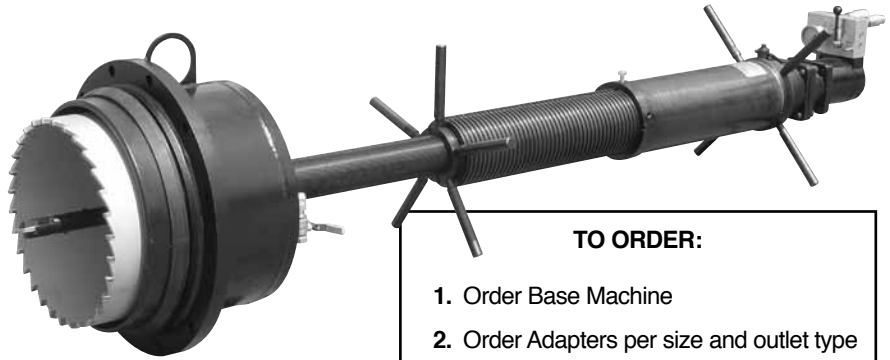

**TO ORDER:**

1. Order Base Machine
2. Order Adapters per size and outlet type
3. Order necessary Cutters.
4. Order extra Spade Bit if doing A/C taps
5. Select Power Unit.

ITEM NUMBER	DESCRIPTION	LIST PRICE
366-00	TapMate XL-424 Drilling Machine Approximate Shipping Weight (base machine and items included with base machine): 650 lbs.	\$21,994.50

<i>Included with base machine</i>					
ITEM NUMBER	DESCRIPTION	LIST PRICE	ITEM NUMBER	DESCRIPTION	LIST PRICE
366-42	Small Adapter Hub (4" - 12")	\$522.50	350-14	TM,Pilot Drill Extension (required for 10" & 12" taps)	\$130.71
366-43	Large Adapter Hub (14" - 24")	599.50	366-66-10	Tool Kit & Spare Parts	473.00
366-38	TM-XL Shaft Nose, Complete (14" - 24")	654.50	366-61	Storage Crate / Work-station	1,083.50
366-39	TM-XL PVC Pilot, Complete (14" - 24")	489.50	372-02-05	1/2" Hose Kit (includes two hoses and two sets of Quick Disconnects)	710.20
350-21-A	TM Shaft Nose, Complete (4" - 12")	327.72			
350-04	TM PVC Pilot (4" - 12")	176.55			

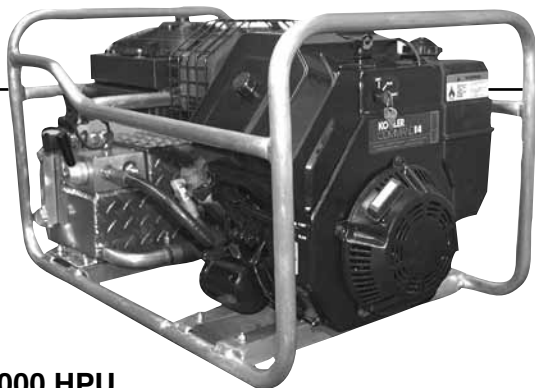

**82000 HPU Hydraulic Power Unit** (also on page TM-27)

- Weighs approximately 200 lbs
- 15 h.p. Kohler gasoline engine
- Hydraulic pump delivering 8 gpm to 2,000 psi
- 4 1/2 gallon hydraulic fluid reservoir
- 12V electric air-to-oil heat exchanger

ITEM NUMBER	DESCRIPTION	LIST PRICE
<b>*372-82000-01</b>	<b>82000 HPU Hydraulic Base Power Unit</b>	<b>\$8,597.88</b>
*Considered Hazardous Material When Shipped by Air		
POWER UNIT ACCESSORIES		
372-02-05	1/2" Hose Kit (includes two Hoses and two sets of Quick Disconnects)	\$710.20
372-02-01	1/2" Hydraulic Hose, 20' Long, 2250WP	ea 160.13
372-13-6	1/2" Male QD Flush Face FF502-8FP	81.54
372-13-7	1/2" Female QD Flush Face FF501-8FP	200.62
372-06-02	Hydraulic Versa Latch (2 req.)	ea 15.07



Transmate

1-800-426-9341



TapMate™ XL-424  
Accessories

ITEM NUMBER	DESCRIPTION	LIST PRICE
<b>ADAPTERS</b>		
350-05-1032	4" MJ Adapter	492.73
350-05-1048	6" MJ Adapter	567.26
350-05-1064	8" MJ Adapter	668.11
350-05-1080	10" MJ Adapter	873.99
350-05-1096	12" MJ Adapter	983.68
366-05-1112	14" MJ Adapter	4,394.50
366-05-1128	16" MJ Adapter	5,164.50
366-05-1144	18" MJ Adapter	5,494.50
366-05-1160	20" MJ Adapter	5,824.50
366-05-1192	24" MJ Adapter	6,044.50
350-05-2032	4" Flange Adapter	492.73
350-05-2048	6" Flange Adapter	581.58
350-05-2064	8" Flange Adapter	668.64
350-05-2080	10" Flange Adapter	1,201.51
350-05-2096	12" Flange Adapter	1,310.91
366-05-2112	14" Flange Adpater	4,394.50
366-05-2128	16" Flange Adpater	5,164.50
366-05-2144	18" Flange Adpater	5,494.50
366-05-2160	20" Flange Adpater	5,824.50
366-05-2192	24" Flange Adpater	6,044.50

Special Adapter Bells (metric sizes and push-on style pipe connections) are also available.

**ADAPTER PARTS**

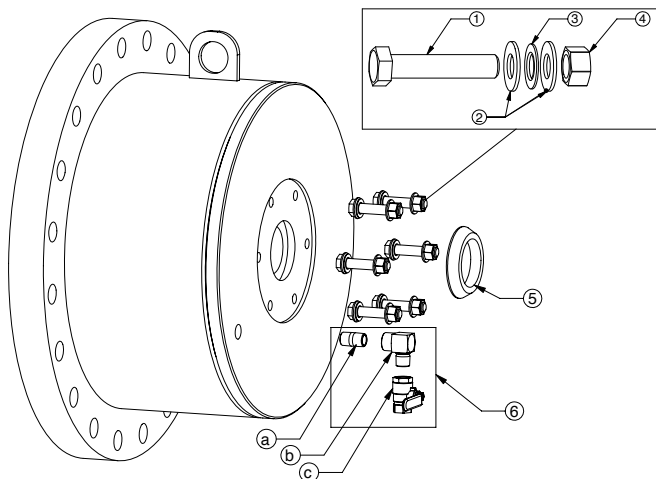

ITEM NUMBER	DESCRIPTION	LIST PRICE
1. 361-06-05	QV Flange Bolt (Qty. 6)	2.57 ea.
2. 8FW-410	Washer (Qty. 12)	1.10 ea.
3. 350-05-80.96-57	TM,Hub Adapter Seals (Qty. 6)	3.27 ea.
4. 350-05-80.96-52	TM,Hub Adapter Nuts (Qty. 6)	2.19 ea.
5. 8r201S0300	Gasket (Qty. 1)	3.85
6. 366-05-01	TM-XL, Adapter Exhaust Valve (Qty. 1)	42.35
6a. 356-01-03	BT Slide Gate Pipe Nipple (Qty. 1)	1.97
6b. 356-03-04	BT,Exhaust Elbow (Qty. 1)	15.54
6c. 371-02	AD Air Drive Valve (Qty. 1)	20.87

ITEM NUMBER	DESCRIPTION	LIST PRICE		
<b>CUTTERS</b>				
For Ductile, Cast Iron, Steel, A/C & PVC	350-01-1032	4" Carbide Cutter	3 1/2" \$603.13	
	350-01-1048	6" Carbide Cutter	5 1/2" 893.96	
	350-01-1064	8" Carbide Cutter	7 1/2" 1,182.42	
	350-01-1080 <sup>1</sup>	10" Carbide Cutter	9 1/2" 2,640.28	
	350-01-1096 <sup>1</sup>	12" Carbide Cutter	11 1/2" 3,122.92	
	366-02-1108	14" Carbide Cutter	13 1/2" 3,850.00	
	366-02-1124	16" Carbide Cutter	15 1/2" 5,225.00	
	366-02-1140	18" Carbide Cutter	17 1/2" 5,775.00	
	366-02-1156	20" Carbide Cutter	19 1/2" 6,737.50	
	366-02-1180	24" Carbide Cutter	22 1/2" 7,837.50	
	For HDPE & PVC	350-01-2032 <sup>2</sup>	4" Cutter for HDPE & PVC Pipe	3 1/2" 601.72
		350-01-2048 <sup>2</sup>	6" Cutter for HDPE & PVC Pipe	5 1/2" 891.79
350-01-2064 <sup>2</sup>		8" Cutter for HDPE & PVC Pipe	7 1/2" 1,177.29	
350-01-2080 <sup>1,2</sup>		10" Cutter for HDPE & PVC Pipe	9 1/2" 2,633.70	
350-01-2096 <sup>1,2</sup>		12" Cutter for HDPE & PVC Pipe	11 1/2" 3,116.40	
366-01-2108 <sup>2</sup>		14" Cutter for HDPE & PVC Pipe	13 1/2" 3,850.00	
366-01-2124 <sup>2</sup>		16" Cutter for HDPE & PVC Pipe	15 1/2" 5,225.00	
366-01-2140 <sup>2</sup>		18" Cutter for HDPE & PVC Pipe	17 1/2" 5,775.00	
366-01-2156 <sup>2</sup>		20" Cutter for HDPE & PVC Pipe	19 1/2" 6,737.50	
366-01-2180 <sup>2</sup>		24" Cutter for HDPE & PVC Pipe	22 1/2" 7,837.50	
For Steel	350-01-5032	4" Cutter for Steel	3 1/2" 603.13	
	350-01-5048	6" Cutter for Steel	5 1/2" 893.96	
	350-01-5064	8" Cutter for Steel	7 1/2" 1,182.42	
	350-01-5080 <sup>1</sup>	10" Cutter for Steel	9 1/2" 2,640.28	
	350-01-5096 <sup>1</sup>	12" Cutter for Steel	11 1/2" 3,124.31	

<sup>1</sup> 10" and 12" Cutters require the Pilot Drill Extension  
<sup>2</sup> HDPE Pilot needed (350-04H) if tapping HDPE pipe only

ITEM NUMBER	DESCRIPTION	LIST PRICE
<b>ACCESSORIES</b>		
350-03-08	1" Spade Bit	\$87.38
358-88	1 3/8" Spade Bit	172.22
350-04H	HDPE Pilot	331.84
350-52	Cutter Jam Nut	50.41
353-10-1	Tapping Compound	28.80
350-05-571	Adapter O-Ring	14.92
366-44	TM-XL Adapter Hub O-Ring	3.03
366-68	TM-XL Anti-Seize Lubricant	18.37

**NEW 14" - 24" ROMAC CUTTERS**

Can be adapted to fit other manufacturer's tapping machines. Contact Romac for pricing and availability.



TM-9